

AIR DRY CONNECT

PRODUCT DATA SHEET



Innovative Insulation Solutions

COMPANY

Quik-Therm Insulation Solutions Inc. is a Canadian-owned insulation panel manufacturer based in Winnipeg, Manitoba. As a company, we are focused on providing innovative, high-performance insulation solutions rooted in rigorous industry testing and advanced building science techniques.

DESCRIPTION

Quik-Therm Air Dry Connect (ADC) insulation panels are composed of Type II closed-cell expanded polystyrene (EPS) core with a proprietary product design which includes plywood furring strips (3" wide x 3/4" thick) embedded into the foam panels and sealed in place with perforated reflective polymer facers on both sides. Embedded furring strips are spaced 16" on center (12" and 24" o/c spacing available upon request). ADC panels are manufactured in 4' x 8' sheet size and available in 2" - 6" thicknesses (including 1/2" increments).

INTENT

ADC panels simplify your building envelope assemblies by allowing you to eliminate thermal clips, long masonry ties, Z-girts and additional strapping by acting as both the framing support and cladding attachment, all in one.

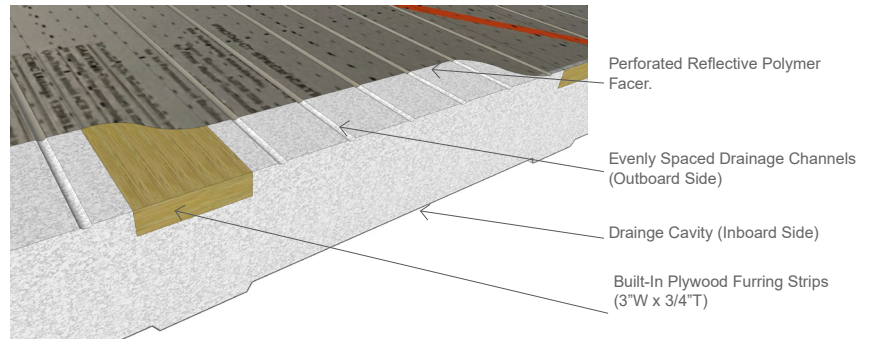

AVAILABILITY

For additional information or special size inquiries, please contact a sales representative at 1-(204)-736-3012 or toll free at 1-(888)-735-3012 or Email: info@quiktherm.com

INSTALLATION

Quik-Therm Air Dry Connect insulation panels may be installed in any orientation (vertical, horizontal or diagonal) and can be easily cut and modified with a hot knife cutter and/or saw. Align built-in furring strips directly over framing members. Once installed, Quik-Therm Air Dry Connect insulation panels may be left exposed for up to 60 days. Prior to installation, ensure to review applicable local building code requirements.



Hot knife cutter profiled to match 3" x 3/4" built-in furring allows you to easily embed additional furring strips into the insulation sheet as required to suit the design and construction methods.

QUIK-THERM EFFECTIVE THERMAL RESISTANCE

Quik-Therm Thickness	2x4 Wood Frame w/ R-12 Batt	2x6 Wood Frame w/ R-20 Batt	Wood Frame Empty Cavity	2x6 Steel Frame w/ R-20 Batt	CMU Wall Int. Insulation	CMU Wall Ext. Insulation
2"	23	28	13	19	13	10
3"	28	32	17	23	18	15
4"	32	36	21	27	22	19
5"	36	40	25	31	26	23
6"	40	44	29	35	30	27

Effective R-values have been modeled and confirmed by third-party testing.

PRODUCT ADVANTAGES

Moisture Management: Promotes moisture management through inward and outward drying for a more sustainable, energy-efficient wall assembly. Unobstructed drainage cavity on inboard side include air drainage planes covering 75% of the panel surface, reducing hydrostatic pressure and allowing moisture to dry to the exterior.

Simplified Assemblies: Air Dry Connect insulation panels offer a significant time, labour and material cost-saving alternative to traditional rigid insulation and strapping/clip assemblies. This solution simplifies cladding installation on wood framing, steel framing, and CMU structures while minimizing thermal bridging and preserving high effective R-values.

Air Barrier: When insulation joints are foamed and taped properly as part of Quik-Therm 936 Connect System (residential application), Air Dry Connect insulation acts as the primary continuous air barrier. Refer to installation guide for qualifying assemblies and detailed instructions.



PERFORMANCE DATA

Test Method	Property	Nominal Value
ASTM D2126	Dimensional Stability Maximum Linear Change, %	1.5
--	Length Tolerance, mm (in)	±3.2 (±0.125)
--	Width Tolerance, mm (in)	±1.6 (±0.063)
ASTM C518	Nominal R-Value	4.18
ASTM D1622	Nominal Density, pcf (kg/m ³)	1.4 (23)
ASTM 1621-04	Compressive Strength, psi (kPa)	136 (19.7)
ASTM E96	Water Vapour Transmission, perms	>1.0 (87)
	Long Term Thermal Resistance	Thermal Resistance Remains Stable Over Life of Service
ASTM D2863-97	Limiting Oxygen Index	26%
CAN/ULC - S102.2	Flame Spread	250
CAN/ULC - S102.2	Smoke Developed	410

Quik-Therm Insulation properties meet or exceed requirements of CAN/ULC-S701-05

QUIK-THERM INSULATION SYSTEMS

Quik-Therm Air Dry Connect insulation panels can be used in commercial and residential applications. Where ADC panels are used in a residential application as an exterior insulated sheathing, please refer to the 936 Connect System. In an application where multiple insulation layers are required, please refer to the Matrix System.

RESIDENTIAL:
936 CONNECT SYSTEM



COMMERCIAL:
MATRIX SYSTEM